

Jira integration

To integrate into your Jira account:

1. Go to **Settings > Integrations > Jira**

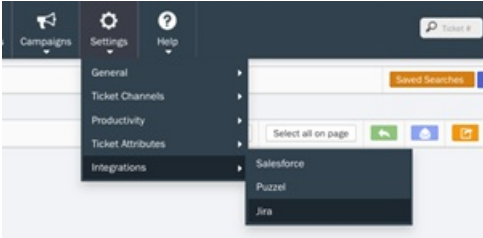

2. Fill-out the account credential form



Your Jira Account is not connected.

Please provide your Account Credentials below:

Site URL

Project Key

User Email

User API Token

- Site URL - This is your JIRA's site URL
 - Project Key- This is your Jira Software's Project Key which you set upon creating your project and it can also be seen in your browser's address bar (e.g. <https://your-site-name.atlassian.net/secure/RapidBoard.jspa?rapidView=1&projectKey=your-project-key>) **NOTE:** Project Key is case-sensitive.
 - User Email- Your JIRA's user email.
 - User API Token- This is your Jira Software's API Token of a user which you created for API usage or purposes and can also be seen by navigating thru the top/main menu
Your Avatar > Account Settings > Security (sidebar) > API token > Create and manage API tokens
3. Once you filled-out the fields with the correct credentials, Your Jira account will be connected. You may choose also to edit credentials or disconnect your account.

Jira Software



Thank you for connecting your Jira Account!

Site URL	https://companyname.atlassian.net
Project Key	CO
User Email	username@company.com

Edit Credential

Disconnect