

## Jira integration

To integrate into your Jira account:

1. Go to **Settings > Integrations > Jira**

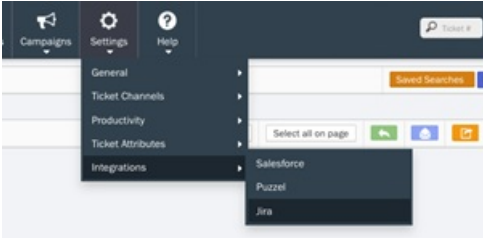

2. Fill-out the account credential form



**Your Jira Account is not connected.**

Please provide your Account Credentials below:

Site URL

Project Key

User Email

User API Token

- Site URL - This is your JIRA's site URL
  - Project Key- This is your Jira Software's Project Key which you set upon creating your project and it can also be seen in your browser's address bar (e.g. <https://your-site-name.atlassian.net/secure/RapidBoard.jspa?rapidView=1&projectKey=your-project-key>) **NOTE:** Project Key is case-sensitive.
  - User Email- Your JIRA's user email.
  - User API Token- This is your Jira Software's API Token of a user which you created for API usage or purposes and can also be seen by navigating thru the top/main menu   
Your Avatar > Account Settings > Security (sidebar) > API token > Create and manage API tokens
3. Once you filled-out the fields with the correct credentials, Your Jira account will be connected. You may choose also to edit credentials or disconnect your account.

# Jira Software



Thank you for connecting your Jira Account!

<b>Site URL</b>	https://companyname.atlassian.net
<b>Project Key</b>	CO
<b>User Email</b>	username@company.com

Edit Credential

Disconnect